



TRIVOLT
industries

ALUMA IMMERSION HEATERS

- **High power, low density** to minimize carbonization.
- **Vertical fins** easy flow for fluids.
- **Compact** design.
- **Up to 300 watts per linear inch** maintaining 10 watts per square inch.
- Aluma heaters allow **skid manufacture to down size vessel** and maintain the same power, resulting in large savings.
- Aluma heaters generate **more power per linear inch** than traditional immersion heaters. Users can increase production capacity if required by using our Aluma Immersion without any mechanical change to their vessel.

Electrical and Mechanical Specifications

3 inch flange 1 leg

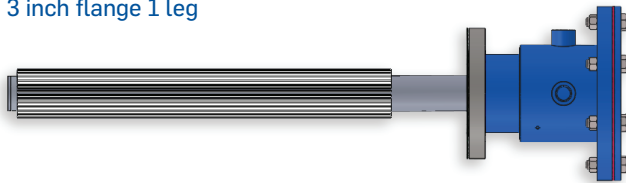

6 inch flange up to 2 legs

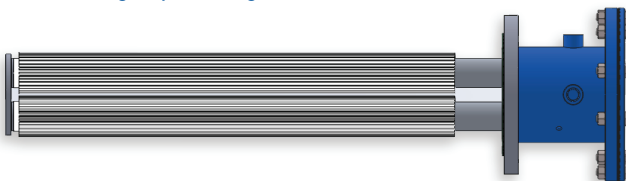

8 inch flange up to 4 legs

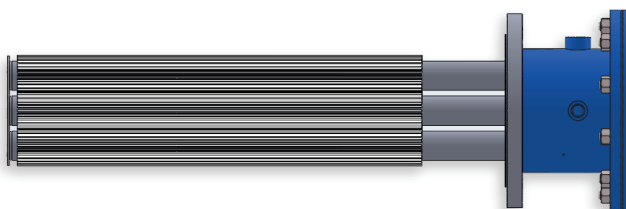

10 inch flange up to 6 legs

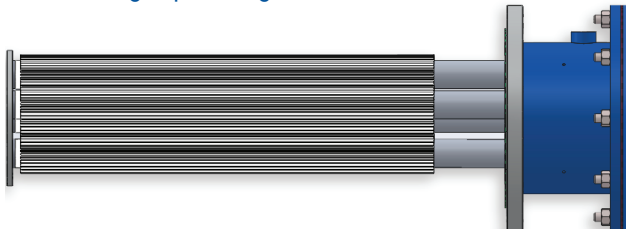

Aluminum extrusion 6061 T.

Available 150 lbs flange up to 600 lbs.

From 3 to 36 inch flange.

Up to 300 watts per linear inch and maintain 10 watts per square inch.

High limit TC available, assembled on heater.

Process TC available, assembled on heater.

Maximum operating sheath temperature of 350 °F.

Electrical connection with separate terminal block for easy connection.

Up to 98 inches in B-dimension.

Available voltage is 120 volts up to 600 volts, single-phase or three-phase, multiple stages.

Anti-corrosion treatment (TVC-01) option available on all heaters.

Nema 1, Nema 4, Nema 4x, Hazloc available on all heaters.

CSA, C-UL certified.

More details online: tri-volt.com